

VH221-A4-A0 Series

HD 4MP IP IR Minidome Camera

Infinova[®]
The Integrator's Manufacturer



- 1/3" CMOS sensor
- IR-Cut Removable (ICR) Filter for Day/Night switching
- 30m IR distance
- Uses Smart-IR technology; auto-adjusts IR lamp power according to ambient illumination
- Supports multi-frame integration WDR, with dynamic range up to 120dB
- Smart functions, such as perimeter protection (wire cross and regional invasion detection) and feature protection (field of view change, defocus, color cast, too dark and too light detection)
- Built-in motorized zoom lens, supporting assistant focusing
- H.265+M-JPEG or H.264+M-JPEG video encoding, three streams
- Maximum resolution supports 2592×1520@20fps, 2560×1440@25fps
- Bi-directional audio, G.711a/G.711u optional
- Supports corridor mode
- Local PC recording
- Supports TF card storage/NAS storage
- Support alarm recording and event recording (including broken network)
- Supports alarm snapshot and event snapshot
- Supports multiple alarm trigger methods such as I/O input, broken network, motion detection, video tampering, smart detecting, etc.; supports flexible alarm association settings like I/O output, emails, FTP picture uploading, audio, TF card recording and alarm information push
- Up to eight ROI (Region of Interest) areas
- Supports motion detection, 4 areas configurable
- Supports privacy mask, 4 privacy areas configurable
- Supports live access and parameter setting via Web Server from multiple users
- Compatible with digital video surveillance software like InfinovaV2216
- Standard SDK provided for easy integration with other video surveillance software
- ONVIF Profile S compliant
- New structure design, surface mount; bracket mount can be achieved when using installation accessories
- 3-axis adjustment
- IP66 rating

● PoE/12VDC/24VAC

VH221-A4 Series is an Infinova HD 4MP WDR IR Smart IP Minidome Camera. It adopts a 1/3" progressive scan CMOS sensor with an internal 2.8mm-12mm HD motorized zoom lens. The camera has an internal dot matrix LED IR lamp of 30m IR distance. The IR lamp output power can be adjusted automatically according to the brightness of the scene so that the IR lamp is not working at full capacity. The power consumption of the complete machine is greatly lowered and the service life is lengthened.

The camera supports up to 2592×1520@20fps HD network video output. It uses H.265/H.264/M-JPEG encoding. The output gives excellent definition and color reproduction. More detailed and accurate information can be acquired and the accuracy of smart analysis can be guaranteed more effectively.

Compact structure makes it easy to install. Also, this camera provides 3-axis adjustment, easy to adjust the monitoring angle.

The products can be widely used in sites that demand high definition image quality with no lighting of ordinary buildings, supermarkets, hotels, shops, parks, schools, factories, warehouses, underground parking lots, etc.

Technical specifications

Image Sensor	1/3" CMOS	Alarm	2 alarm inputs, 1 on-off output
Lens Configuration	Motorized zoom lens, F1.4, f=2.8-12mm	Smart Functions	Video anomaly detection, Wire cross, regional invasion detection
Lens Mount	Φ12	Network Delay	≤250ms
IR Lamp Wave Length	850nm	Motion Detection	Supports up to 4 motion detecting areas
Night Vision Distance	30m	Privacy Mask	Up to 4 masks
Camera Angle Adjustment	X (Panning): 0°~360°; Y (Tilting): 0°~72°; Z (Rotating): 0°~360°	ROI	Up to 8 regions
Day/Night Switching	ICR	Internal Storage	Supports a Micro SD/SDHC/SDXC card (128G)
Sensitivity	Color mode: 0.01 Lux@F1.4(30IRE, AGC ON); B/W mode: 0 lux (IR ON)	Mirroring Storage	Supports uploading of recordings saved on TF card during network disconnection to the VMS or NVR after network recovery
S/N Ratio	52dB	Local PC Recording	Available
Exposure	Scene, Manual, Shutter	Remote Network Upgrade	Available
Shutter	Auto/Manual (adjustment range 1/1s~1/32000s)	Security	Password protection, IP Address Filtering, User Access Log
AGC	Auto/Manual adjustable, max. 64X	Network Port	One RJ45 10/100M self-adaptive Ethernet port
White Balance	Auto/Manual/Outdoor	Analog Video Output	Available, BNC connector
WDR	Supports multi-frame integration mode wide dynamic range up to 120dB	Network Protocols	IPv4, IPv6, TCP, UDP, IGMP, DHCP, FTP, SNMP (V3), SMTP, NTP, RTP, RTSP, RTCP, HTTP, HTTPS, TSL, SSL, 802.1X, QoS, PPPoE, DNS, DDNS, ARP, ICMP, UPnP
Video Adjustment	Brightness, contrast, saturation, chroma, sharpness	Power Supply	PoE (IEEE 802.3af)/12VDC/24VAC
Noise Reduction	3D	Power	<9W
Defog	Available	Protection Design	Lighting protection (network port and power supply connector): protection differential mode 2KV, common mode 2KV surge; Anti-static (all ports): contact protection 6KV static
EIS	Available	Operating Temperature	-40°F ~ 140°F (-40°C ~ 60°C)
Corridor Mode	Available	Storage Temperature	-4°F ~ 140°F (-20°C ~ 60°C)
Image Mirror	Horizontal/Vertical mirror	Operating Humidity	0%~95% RH (non-condensing)
Video Compression	H.265/H.264 switchable M-JPEG independent	Unit Dimensions (H×Ø)	4.02"×5.43" (102.1mm×137.8mm)
Max. Encoding Capacity	2592×1520@20fps+720P@30fps+M-JPEG1080P@5fps	Box Dimensions (L×W×H)	4.02"×5.43" (102.1mm×137.8mm)
Optional Resolution	Major stream: 2592×1520/2560×1440/2048×1520/2304×1296/1920×1080/1280×960/1280×720; Minor stream: 1920×1080/1280×960/1280×720/720×576/704×576/640×480/352×288/320×240; M-JPEG: 1920×1080/1280×960/1280×720	Unit Weight	1.98lbs. (0.9Kg)
Output Code Rate	Variable; Constant: major stream: 256Kbps~10000Kbps; minor stream: 256Kbps~2000Kbps	Shipping Weight	2.54lbs. (1.15Kg)
Audio	Compression: G.711a, G.711u Sampling rate: 8KHz Port: 1 linear input, 1 linear output	Certifications and Approval	
		Product Certifications	CE/EMC: EN 55032, EN 55024, EN 61000-3-2, EN 61000-3-3 ¹ ; FCC: Part 15 Subpart B Class A ² ; ISO 9001:2008, IP66, IK10, UL ³

Certificate No.: ¹CTL1703238084-EC; ²CTL1703238084-FC; ³E232008-A49

Ordering information

VH221-A40B-A022 HD 4MP WDR IR Smart IP Minidome Camera, 4.0MPx, 1/3 inch CMOS, Day/night, H.265/H.264/M-JPEG, with audio alarm, 2.8~12mm motorized zoom lens, 30m IR distance, Surface mount, Clear Bubble, Vandal-resistant, IP66, PoE/12VDC/24VAC

Accessories

V1761HA	Wall Mount
V1764HA	Pendent Mount

Dimensions

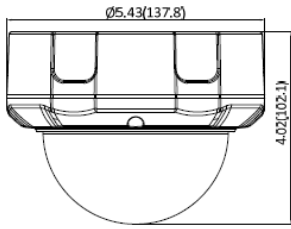

Surface Mount

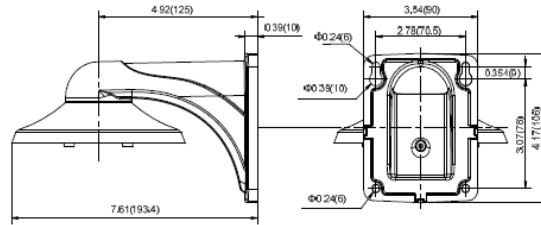

Wall Mount

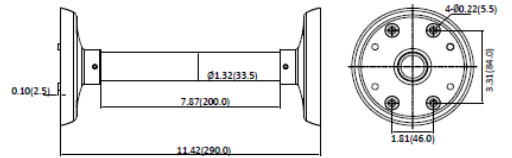

Pendent Mount

(Unit: inch, in the parentheses is mm)